

Nord

RECORD OF FRIABLE AND NON-FRIABLE ACM
(FORM B)

Inspection Date(s) August 6, 2013

THREE-YEAR REINSPECTION

CDS CODE
04-61424-6003057

SCHOOL
Nord Country Day Charter School (FKA Nord Elementary School)

SCHOOL PHONE NUMBER
(530) 891-3138

ADDRESS
5554 California Street

(NUMBER)

(STREET)

(CITY)
Chico, CA

(ZIP)
95926

-IMPORTANT-

Each building and functional space with friable ACM or friable assumed ACM listed on this form requires completion of FORM C (PHYSICAL AND HAZARD ASSESSMENT OF FRIABLE ACM OR FRIABLE ASSUMED ACM). Indicate location of material on blueprint, diagram or narrative in square or linear feet, and attach a copy (Sec. 763.93).

LINE	BUILDING NAME & FUNCTIONAL SPACE <small>(Indicate Address if Different From Above)</small>	CHECK ONE			CHECK ONE			
		SUR-FACING	TSI	MISC	ACBM		ASSUMED ACM	
					FRIABLE	NON-FRIABLE	FRIABLE	NON-FRIABLE
1.	A - ADMINISTRATION	X		X		X		X
2.	B - PORTABLE			X				X
3.	C - MPR	X		X		X		
4.	D - PORTABLE 4 CERTIFIED BY DISTRICT							
5.	E DISTRICT MUST CERTIFY							
6.								
7.								
8.								
9.								
10.								
11.								
12.								
13.								
14.								
15.								
16.								
17.								

See attached "Homogeneous Materials Records" for all materials and their locations by building. On Form B all buildings are listed, and a summary of all non-friable and friable material is provided. Friable materials and their locations are listed separately under each building on Form B.

**THREE-YEAR REINSPECTION
HOMOGENEOUS ACM RECORDS**

Date of Inspection: August 6, 2013

District: Chico Unified School District

Inspector: Blake Howes

School: Nord Country Day Charter (FKA Nord Elementary School)

Building: A - Administration

Material Class	Material	Homo. Mat. #	% Asb.	Ft ² /L.F.	Location	Condition: Code & Comments	Friable Yes/No
M	12" ACOUSTIC CEILING TILE - 1/8" HOLE PATTERN	1	NONE DETECTED	2,500 S	OFFICE (900), CLASSROOM 2, & LIBRARY	(13) SAMPLE HMS-NES-01 COLLECTED ON 3-29-88.	N/A
M	9" VINYL FLOOR TILE (BROWN) & ADHESIVE	2	1-5%	2,400 S	OFFICE (900) AND CLASSROOM 2	(4) (11) COVERED WITH 12" TAN VINYL FLOOR TILE.	N
M	12" VINYL FLOOR TILE (TAN) & ADHESIVE	3	TRACE	1,200 S	OFFICE (900) AND CLASSROOM 2	(1) (4)	N
S	WALL PLASTER	4	TRACE	2,950 S	OFFICE (900), BOYS & GIRLS RESTROOMS (903 & 904), AND STORAGE ROOM (902)	(1) (4)	N
M	2' X 4' FCP - FISSURE PATTERN	102	ASSUMED POSITIVE	1,500 S	CLASSROOMS 1 & 2, LIBRARY	(1) (4)	N
S	STUCCO	150	ASSUMED POSITIVE	UNDETERMINED	COVERED WALKWAY	(13) COVERED WALKWAYS HAVE PLYWOOD OVERHANGS	N
M	COVE BASE ADHESIVE	151	ASSUMED POSITIVE	250 S	THROUGHOUT BUILDING	(1)	N
M	CARPET ADHESIVE	152	ASSUMED POSITIVE	1,000 S	LIBRARY	(1)	N

CONDITION CODE

General Condition: (1) Good (2) Damaged (3) Significantly Damaged (25% or more)

Change in Condition: (4) No (5) Yes (If Yes, explain under comments)

Abated: (6) Repaired (7) Removed (8) Encapsulated (9) Enclosed (10) Isolated & Restricted

Miscellaneous: (11) Inaccessible, no inspection data (12) Other (Explain under comments) (13) Non-Asbestos/Not Inspected

CONSULT ORIGINAL AND SUPPLEMENTARY INSPECTION REPORTS FOR MATERIALS WITH TRACE AMOUNTS OF ASBESTOS

**THREE-YEAR REINSPECTION
HOMOGENEOUS ACBM RECORDS**

Date of Inspection: August 6, 2013

District: Chico Unified School District

Inspector: Blake Howes

School: Nord Country Day Charter (FKA Nord Elementary School)

Building: B - Portable 3

Material Class	Material	Homo. Mat. #	% Asb.	Ft ² /L.F.	Location	Condition: Code & Comments	Friable Yes/No
M	2' X 4' CEILING PANELS	100	ASSUMED POSITIVE	900 F	PORTABLE 3	(1) (12) THIS PORTABLE WAS BROUGHT FROM FOREST RANCH. (NO I.D.)	N
M	12" VINYL FLOOR TILE (WHITE) & ADHESIVE	101	ASSUMED POSITIVE	240 S	PORTABLE 3	(1) (4)	N

CONDITION CODE

General Condition: (1) Good (2) Damaged (3) Significantly Damaged (25% or more)

Change in Condition: (4) No (5) Yes (If Yes, explain under comments)

Abated: (6) Repaired (7) Removed (8) Encapsulated (9) Enclosed (10) Isolated & Restricted

Miscellaneous: (11) Inaccessible, no inspection data (12) Other (Explain under comments) (13) Non-Asbestos/Not Inspected

CONSULT ORIGINAL AND SUPPLEMENTARY INSPECTION REPORTS FOR MATERIALS WITH TRACE AMOUNTS OF ASBESTOS

Z:\Clients\Chico USD\13-2751 3 Year Reinspections\Sites\Nord Country Day Charter\Nord HMR.wpd

**THREE-YEAR REINSPECTION
HOMOGENEOUS ACBM RECORDS**

Date of Inspection: August 6, 2013

District: Chico Unified School District

Inspector: Blake Howes

School: Nord Country Day Charter (FKA Nord Elementary School)

Building: C - MPR

Material Class	Material	Homo. Mat. #	% Asb.	Ft ² /L.F.	Location	Condition: Code & Comments	Friable Yes/No
M	12" ACOUSTIC CEILING TILE - SOLID PATTERN	1	NONE DETECTED	1,300 S	MPR (907)	(13) REPRESENTED BY SAMPLE HMS-NES-01 COLLECTED ON 3-29-01.	N/A
S	WALL PLASTER	9	1-5%	1,000 S	STORAGE ROOM (909) & KITCHEN (908)	(2) (6) SOME MINOR DAMAGE & CRACKS THROUGHOUT ROOMS. SOME REPAIRED AREAS.	N
M	9" VINYL FLOOR TILE (DARK GRAY) & ADHESIVE	10	1-5%	1,600 S	MPR (907) & KITCHEN (908)	(2) (5) DAMAGED AT ENTRANCE TO KITCHEN STORAGE/OFFICE AREA.	N
M	9" VINYL FLOOR TILE (OLIVE WITH PINK SPOTS) & ADHESIVE	11	TRACE	100 S	MPR (EASTERN SIDE) (907)	(1) (4)	N

CONDITION CODE

General Condition: (1) Good (2) Damaged (3) Significantly Damaged (25% or more)
Change in Condition: (4) No (5) Yes (If Yes, explain under comments)
Abated: (6) Repaired (7) Removed (8) Encapsulated (9) Enclosed (10) Isolated & Restricted
Miscellaneous: (11) Inaccessible, no inspection data (12) Other (Explain under comments) (13) Non-Asbestos/Not Inspected

CONSULT ORIGINAL AND SUPPLEMENTARY INSPECTION REPORTS FOR MATERIALS WITH TRACE AMOUNTS OF ASBESTOS

Z:\Clients\Chico USD\113-2751 3 Year Reinspections\Sites\Nord Country Day Charter\Nord HMR.wpd

**THREE-YEAR REINSPECTION
HOMOGENEOUS ACBM RECORDS**

Date of Inspection: August 6, 2013

District: Chico Unified School District

Inspector: Blake Howes

School: Nord Country Day Charter (FKA Nord Elementary School)

Building: D - Portable 4

Material Class	Material	Homo. Mat. #	% Asb.	Ft ² /L.F.	Location	Condition: Code & Comments	Friable Yes/No
					PORTABLE 4	(12) THIS PORTABLE HAS BEEN CERTIFIED BY THE DISTRICT. ENTEK DOES NOT CURRENTLY HAVE A COPY OF THE CERTIFICATION LETTER ON FILE.	

CONDITION CODE

- General Condition: (1) Good (2) Damaged (3) Significantly Damaged (25% or more)
Change in Condition: (4) No (5) Yes (If Yes, explain under comments)
Abated: (6) Repaired (7) Removed (8) Encapsulated (9) Enclosed (10) Isolated & Restricted
Miscellaneous: (11) Inaccessible, no inspection data (12) Other (Explain under comments) (13) Non-Asbestos/Not Inspected

CONSULT ORIGINAL AND SUPPLEMENTARY INSPECTION REPORTS FOR MATERIALS WITH TRACE AMOUNTS OF ASBESTOS



Nord Country Day Charter

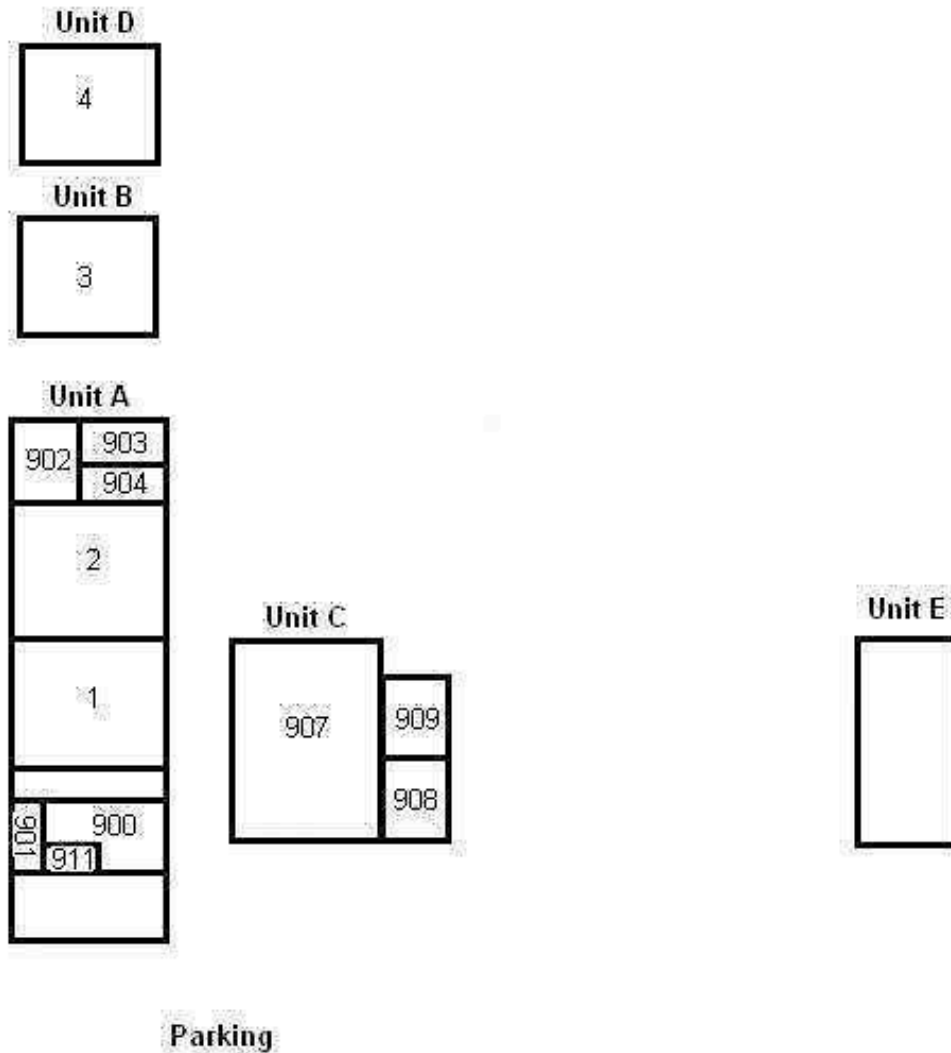

Blake Howes

Chico Unified School District
Nord Country Day Charter
5554 California Street
Chico, CA 95926

Entek Consulting Group, Inc.
4200 Rocklin Road, Suite 7
Rocklin, California 95677
Map Not To Scale

3-Year AHERA Reinspection
Conducted by Blake Howes
August 6, 2013
Project 13-2751

SIX-MONTH SURVEILLANCE

**SIX MONTH SURVEILLANCE
HOMOGENEOUS ACM RECORDS**

Date of Inspection:

District: Chico Unified School District

Inspector:

School: Nord Country Day Charter (FKA Nord Elementary School)

Building: A - Administration

Material Class	Material	Homo. Mat. #	% Asb.	Ft ² /L.F.	Location	Condition: Code & Comments	Friable Yes/No
M	12" ACOUSTIC CEILING TILE - 1/8" HOLE PATTERN	1	NONE DETECTED	2,500 S	OFFICE (900), CLASSROOM 2, & LIBRARY	(13) SAMPLE HMS-NES-01 COLLECTED ON 3-29-88.	N/A
M	9" VINYL FLOOR TILE (BROWN) & ADHESIVE	2	1-5%	2,400 S	OFFICE (900) AND CLASSROOM 2	(4) (11) COVERED WITH 12" TAN VINYL FLOOR TILE.	N
M	12" VINYL FLOOR TILE (TAN) & ADHESIVE	3	TRACE	1,200 S	OFFICE (900) AND CLASSROOM 2	(1) (4)	N
S	WALL PLASTER	4	TRACE	2,950 S	OFFICE (900), BOYS & GIRLS RESTROOMS (903 & 904), AND STORAGE ROOM (902)	(1) (4)	N
M	2' X 4' FCP - FISSURE PATTERN	102	ASSUMED POSITIVE	1,500 S	CLASSROOMS 1 & 2, LIBRARY	(1) (4)	N
S	STUCCO	150	ASSUMED POSITIVE	UNDETERMINED	COVERED WALKWAY	(13) COVERED WALKWAYS HAVE PLYWOOD OVERHANGS	N
M	COVE BASE ADHESIVE	151	ASSUMED POSITIVE	250 S	THROUGHOUT BUILDING	(1)	N
M	CARPET ADHESIVE	152	ASSUMED POSITIVE	1,000 S	LIBRARY	(1)	N

CONDITION CODE

General Condition: (1) Good (2) Damaged (3) Significantly Damaged (25% or more)

Change in Condition: (4) No (5) Yes (If Yes, explain under comments)

Abated: (6) Repaired (7) Removed (8) Encapsulated (9) Enclosed (10) Isolated & Restricted

Miscellaneous: (11) Inaccessible, no inspection data (12) Other (Explain under comments) (13) Non-Asbestos/Not Inspected

CONSULT ORIGINAL AND SUPPLEMENTARY INSPECTION REPORTS FOR MATERIALS WITH TRACE AMOUNTS OF ASBESTOS

**SIX MONTH SURVEILLANCE
HOMOGENEOUS ACBM RECORDS**

Date of Inspection:

District: Chico Unified School District

Inspector:

School: Nord Country Day Charter (FKA Nord Elementary School)

Building: B - Portable 3

Material Class	Material	Homo. Mat. #	% Asb.	Ft ² /L.F.	Location	Condition: Code & Comments	Friable Yes/No
M	2' X 4' CEILING PANELS	100	ASSUMED POSITIVE	900 F	PORTABLE 3	(1) (12) THIS PORTABLE WAS BROUGHT FROM FOREST RANCH. (NO I.D.)	N
M	12" VINYL FLOOR TILE (WHITE) & ADHESIVE	101	ASSUMED POSITIVE	240 S	PORTABLE 3	(1) (4)	N

CONDITION CODE

General Condition: (1) Good (2) Damaged (3) Significantly Damaged (25% or more)

Change in Condition: (4) No (5) Yes (If Yes, explain under comments)

Abated: (6) Repaired (7) Removed (8) Encapsulated (9) Enclosed (10) Isolated & Restricted

Miscellaneous: (11) Inaccessible, no inspection data (12) Other (Explain under comments) (13) Non-Asbestos/Not Inspected

CONSULT ORIGINAL AND SUPPLEMENTARY INSPECTION REPORTS FOR MATERIALS WITH TRACE AMOUNTS OF ASBESTOS

**SIX MONTH SURVEILLANCE
HOMOGENEOUS ACBM RECORDS**

Date of Inspection:

District: Chico Unified School District

Inspector:

School: Nord Country Day Charter (FKA Nord Elementary School)

Building: C - MPR

Material Class	Material	Homo. Mat. #	% Asb.	Ft ² /L.F.	Location	Condition: Code & Comments	Friable Yes/No
M	12" ACOUSTIC CEILING TILE - SOLID PATTERN	1	NONE DETECTED	1,300 S	MPR (907)	(13) REPRESENTED BY SAMPLE HMS-NES-01 COLLECTED ON 3-29-01.	N/A
S	WALL PLASTER	9	1-5%	1,000 S	STORAGE ROOM (909) & KITCHEN (908)	(2) (6) SOME MINOR DAMAGE & CRACKS THROUGHOUT ROOMS. SOME REPAIRED AREAS.	N
M	9" VINYL FLOOR TILE (DARK GRAY) & ADHESIVE	10	1-5%	1,600 S	MPR (907) & KITCHEN (908)	(2) (5) DAMAGED AT ENTRANCE TO KITCHEN STORAGE/OFFICE AREA.	N
M	9" VINYL FLOOR TILE (OLIVE WITH PINK SPOTS) & ADHESIVE	11	TRACE	100 S	MPR (EASTERN SIDE) (907)	(1) (4)	N

CONDITION CODE

General Condition: (1) Good (2) Damaged (3) Significantly Damaged (25% or more)

Change in Condition: (4) No (5) Yes (If Yes, explain under comments)

Abated: (6) Repaired (7) Removed (8) Encapsulated (9) Enclosed (10) Isolated & Restricted

Miscellaneous: (11) Inaccessible, no inspection data (12) Other (Explain under comments) (13) Non-Asbestos/Not Inspected

CONSULT ORIGINAL AND SUPPLEMENTARY INSPECTION REPORTS FOR MATERIALS WITH TRACE AMOUNTS OF ASBESTOS

**SIX MONTH SURVEILLANCE
HOMOGENEOUS ACBM RECORDS**

Date of Inspection:

District: Chico Unified School District

Inspector:

School: Nord Country Day Charter (FKA Nord Elementary School)

Building: D - Portable 4

Material Class	Material	Homo. Mat. #	% Asb.	Ft ² /L.F.	Location	Condition: Code & Comments	Friable Yes/No
					PORTABLE 4	(12) THIS PORTABLE HAS BEEN CERTIFIED BY THE DISTRICT. ENTEK DOES NOT CURRENTLY HAVE A COPY OF THE CERTIFICATION LETTER ON FILE.	

CONDITION CODE

General Condition: (1) Good (2) Damaged (3) Significantly Damaged (25% or more)

Change in Condition: (4) No (5) Yes (If Yes, explain under comments)

Abated: (6) Repaired (7) Removed (8) Encapsulated (9) Enclosed (10) Isolated & Restricted

Miscellaneous: (11) Inaccessible, no inspection data (12) Other (Explain under comments) (13) Non-Asbestos/Not Inspected

CONSULT ORIGINAL AND SUPPLEMENTARY INSPECTION REPORTS FOR MATERIALS WITH TRACE AMOUNTS OF ASBESTOS